

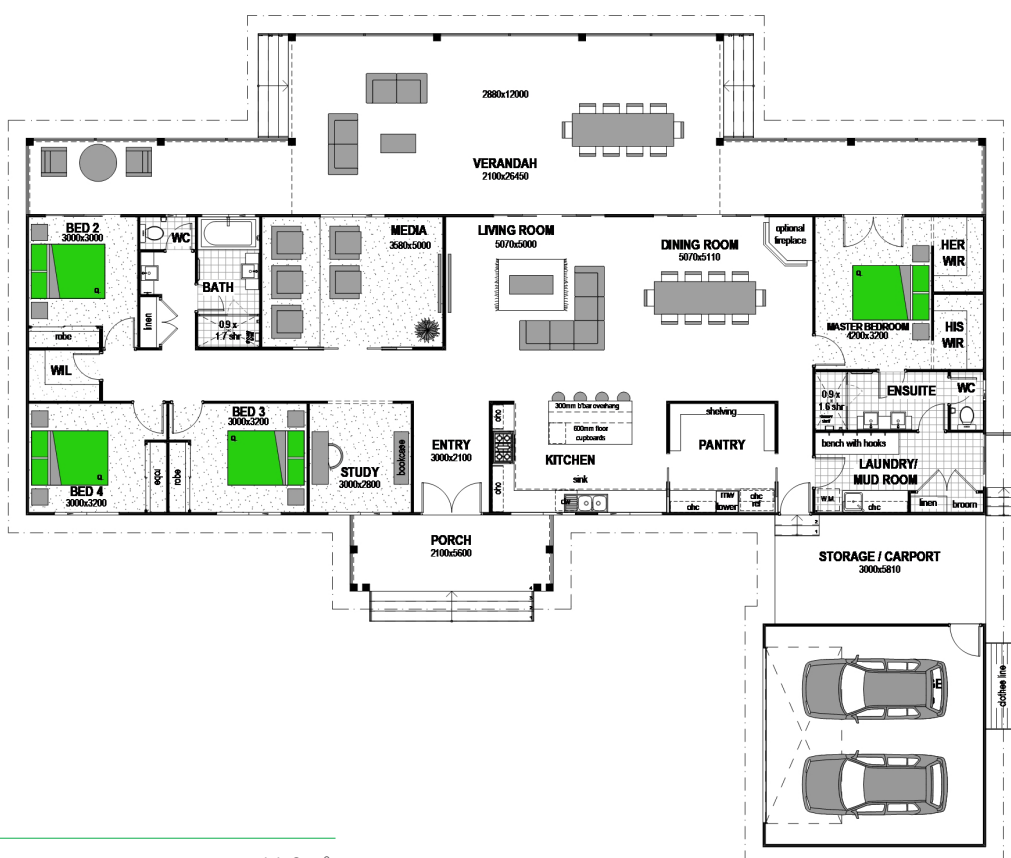

Country Façade

4 2 3

Waratah 376



Floor Areas

| | |
|-----------------|------------------------------------|
| Porch | 11.8m ² |
| Verandah | 90.1m ² |
| Open Bay Garage | 17.4m ² |
| Garage | 37.7m ² |
| Living | 219m ² |
| TOTAL | (40.5sqsq) 376m² |
| Width | 26.5m |
| Depth | 22.4m |

Features

- Walk-In Linen
- Media
- Study
- Walk-In Pantry

Floor plan and dimensions shown are for the Country Façade.