



Alpine Façade

4 2 2

# Kentucky 364



On display with Stroud Homes  
Brisbane South.

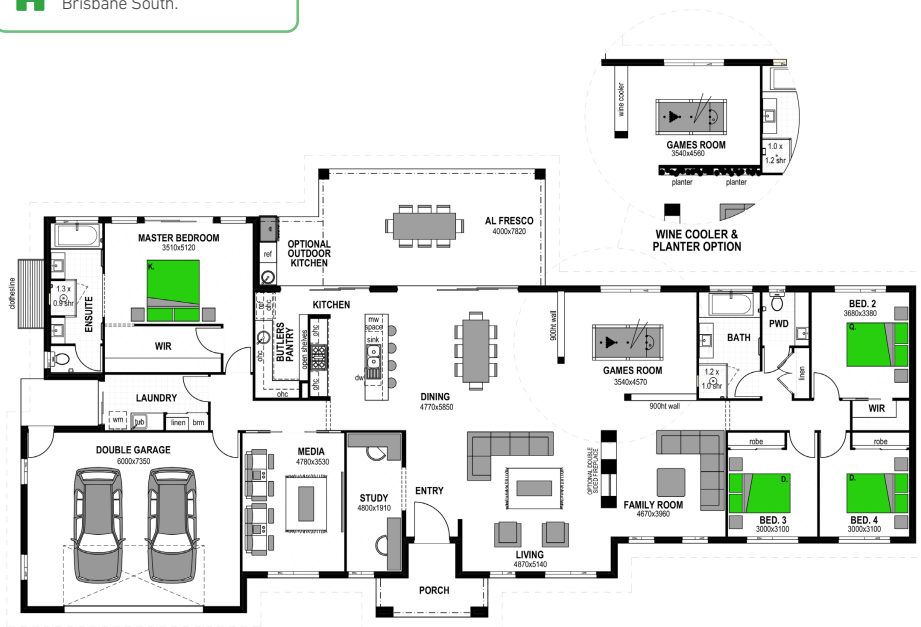

Colonial Façade



Hamptons Façade



Classic Façade



Mountain Façade



Portico Façade

## Floor Areas

Porch	7.2m <sup>2</sup>
Laundry Patio	4.3m <sup>2</sup>
Alfresco	36.2m <sup>2</sup>
Garage	47.9m <sup>2</sup>
Living	269.3m <sup>2</sup>
<b>TOTAL</b>	<b>(39.3sqs) 364.9m<sup>2</sup></b>
Width	30.9m
Depth	15.5m

Floor plan and dimensions shown are for the Classic Façade.

## Features

- Family Room
- Media
- Games Room
- Study
- Butler's Pantry