

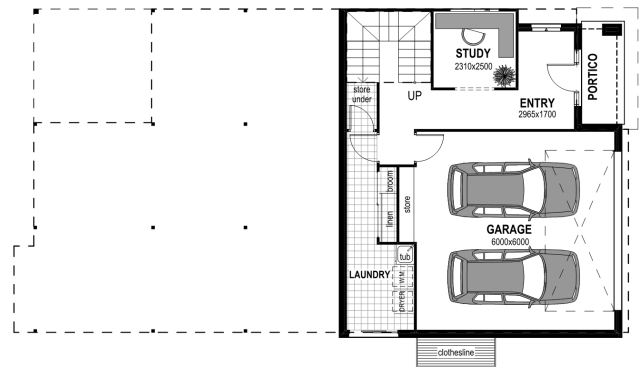

Scandi Façade

4 2 2

# Kaydon 255 - Sloped Block



## Floor Areas

Ground Floor Living	39.7m <sup>2</sup>
Upper Floor Living	159.7m <sup>2</sup>
Alfresco	12.3m <sup>2</sup>
Porch	3.8m <sup>2</sup>
Garage	40.2m <sup>2</sup>
<b>TOTAL</b>	<b>(27.5sqs) 255.7m<sup>2</sup></b>
Width	9.9m
Depth	18.6m

Floor plan and dimensions shown are for the Classic Façade.

## Features

- Study
- Walk-In Linen
- Walk-In Pantry
- Child's Retreat

