

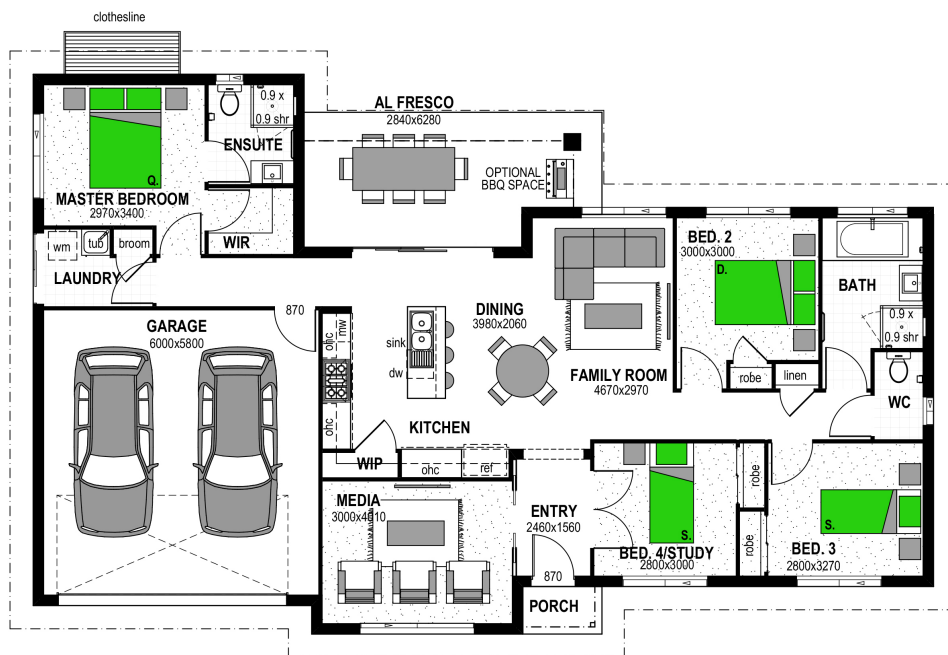

Hamptons Façade

4 2 2

# Beechmont 188



## Floor Areas

Porch	1.6m <sup>2</sup>
Alfresco	16.8m <sup>2</sup>
Garage	37.4m <sup>2</sup>
Living	132.9m <sup>2</sup>
<b>TOTAL</b>	<b>(20.3sqs) 188.7m<sup>2</sup></b>
Width	19m
Depth	11.8m

Floor plan and dimensions shown are for the Classic Façade.

## Features



Colonial Façade



Skillion Façade



Classic Façade - Option 1



Coast Façade



Scandi Façade

More Façades available. Speak with our team or see [www.stroudhomes.com.au](http://www.stroudhomes.com.au) to see the full range.